



FOR SALE

Offers in Excess of £260,000

20 St. Augustine Road,
Southsea, PO4 9AD.

Tenure: Freehold

ESTATE  AGENTS

LAWSON ROSE

PROPERTY DESCRIPTION

This three bedroom mid-terrace home is available to purchase with no forward chain and is located close to Albert Road with all the shops, bars and eateries close by. Situated on St Augustine Road, The interior accommodation comprises of a large entrance hallway with rooms leading to a living room with a large bay window and a secondary reception currently used for storage. Moving through the hallway is a fitted kitchen/ breakfast room with a lobby leading to a modern bathroom suite and a separate W.C. The first floor then provides three great sized double bedrooms, all of which have built in wardrobes plus outside the home is a well kept enclosed rear garden. Given the property's location and size, it could be well suited to a first time or family home and we highly recommend an internal viewing. For further information or to make an appointment to view, please contact the Lawson Rose sales office today.

Material Information:

- Construction: Brick Built
- Electricity Supply: Alternating Current
- Heating: Gas Central Heating
- Water Supply: Mains Water Supply
- Sewage: Mains Sewage
- Broadband: Standard, Superfast Fibre and Gfast Fibre are available.
- Mobile: Ofcom Checker shows EE, Three, O2 and Vodafone all have voice and data availability in this area.
- Permit Parking: 1st permit is £30, 2nd permit is £120 and 3rd permit (where available) is £300.
- Council Tax: Portsmouth City Council – Band B
- Flood Risk – Low Risk (Stated on the Gov.uk portal)



02392 367 779 - contactus@lawsonrose.com
131 Winter Road, Southsea, PO4 8DS





GROUND FLOOR

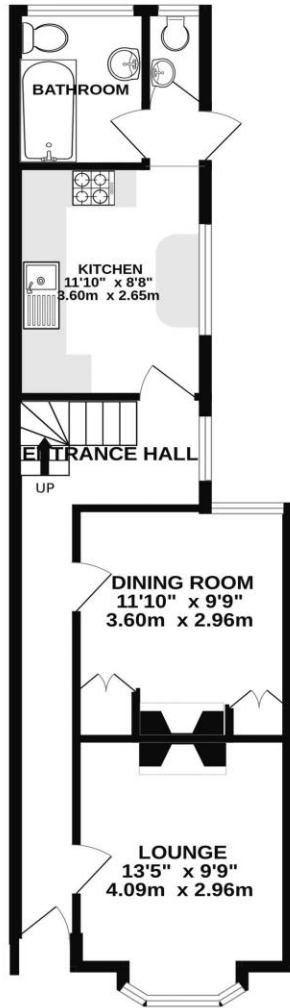

1ST FLOOR

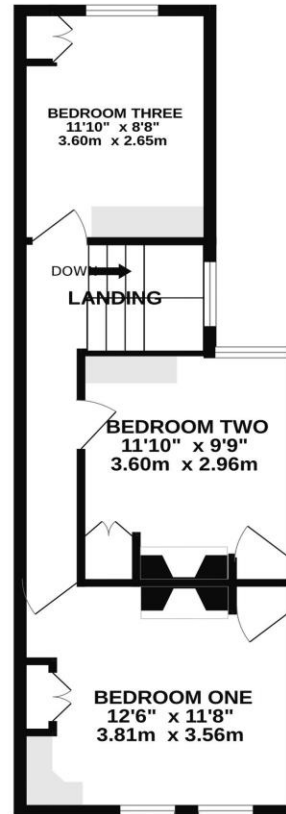

Please note that none of the services or appliances have been tested by Lawson Rose Estate Agents.